

LOT 2 CORNWALL TWP.
"1862"

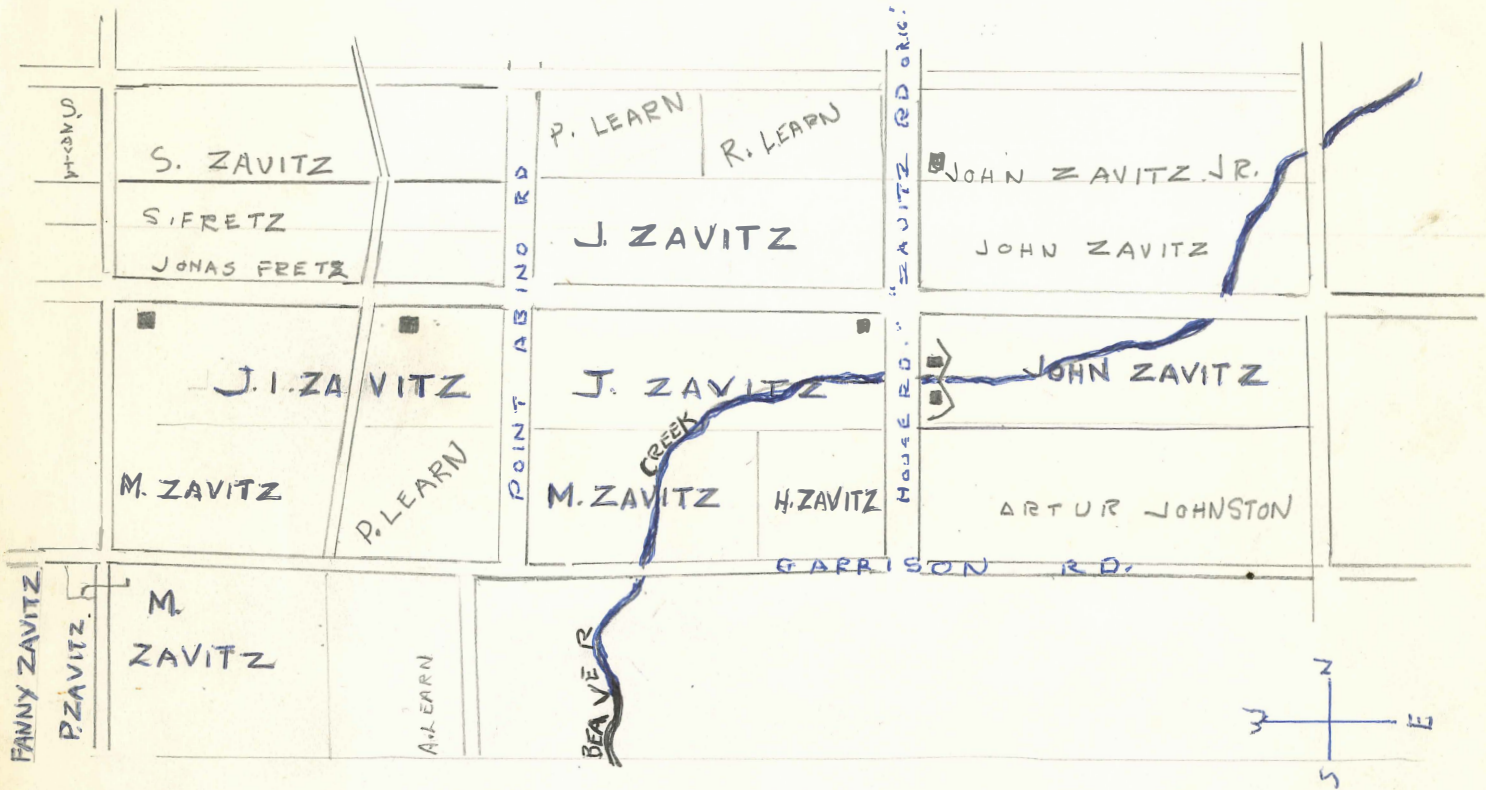

ZAVITZ:::

lot #2 con 13 N. R. Bertie
on Beaver Creek. North of Garrison rd.

1808

Crystal Zavitz came with his family from the U S.A. to this land and built a grist mill and his son alter added a saw mill. During the war of 182 it served the troops at the old Fort with flour.

1851: John Zavitz operated a saw mill, powered by water, which ran for only three months during the year. It cuts about fifteen thousand feet of lumber annually.