

LOT 8 CON 3, E 4.

CHRISTIAN RISELAY

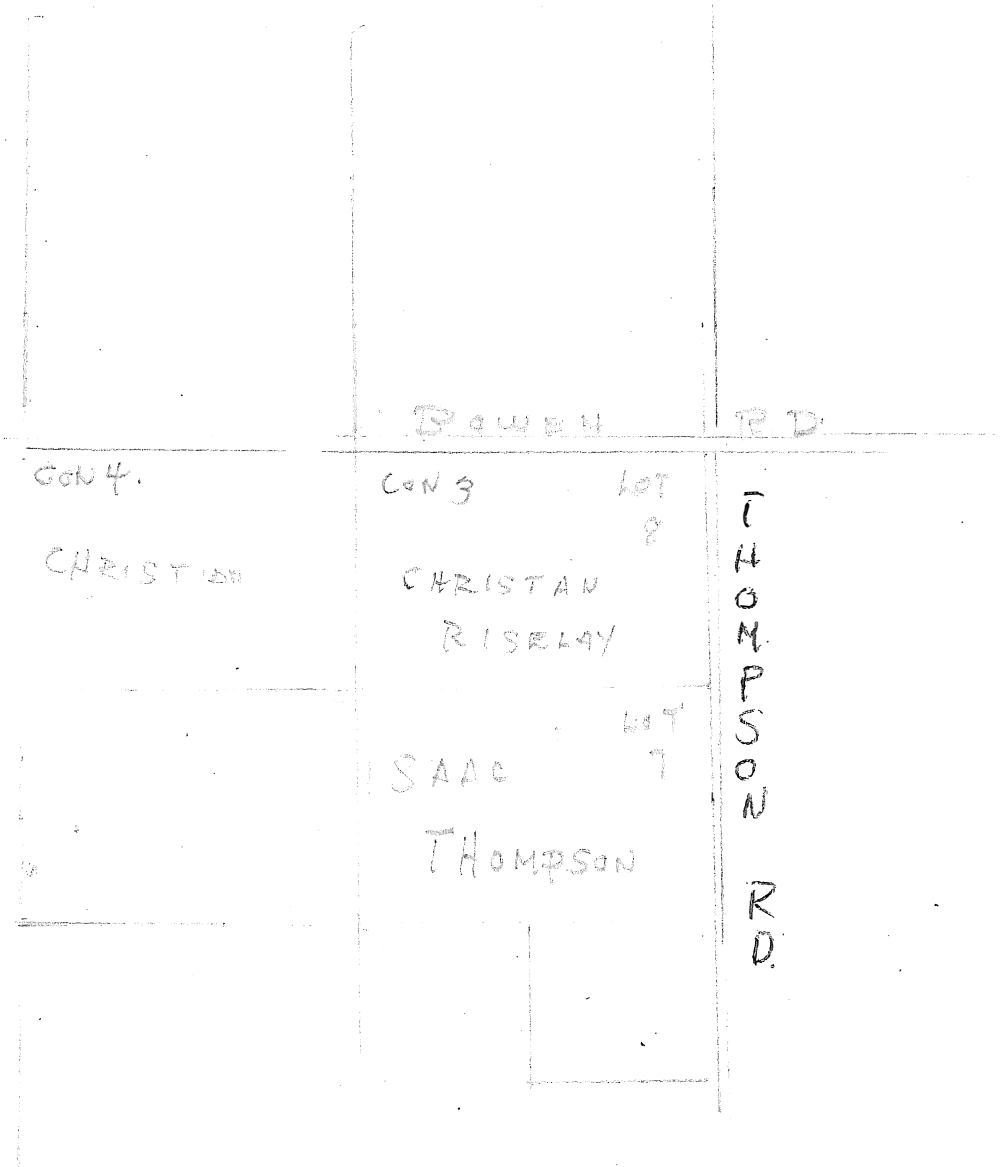

Lot 8 con. 3. N.R. Riselay.

Pt. Apr. 5, 1797. Crown to Christian Riselay : 100 acres.

Pt. Deed. Dec. 22, 1829. Edmund Riselay to John Riselay : 200 acres.
lot 8 con 3 & 4.

B.&.S. John Risealy to the Great Western Railway Comp.
14/ 9/100 acres . pt. 8. con. 3 &4.

Prob. of will: Mar. 1868. John Risealy bequeathed to son Cranmer
2174. all his estate.

Priate of Will: Cranmer Riselay bequeathed to his wife
Margaret all his estate.

CON 3 LOT 3 CON 1 LOT 10.
 CON 4 LOT 8
 LANDS OF CHRISTIAN RICELEY
 BERTIE 1795

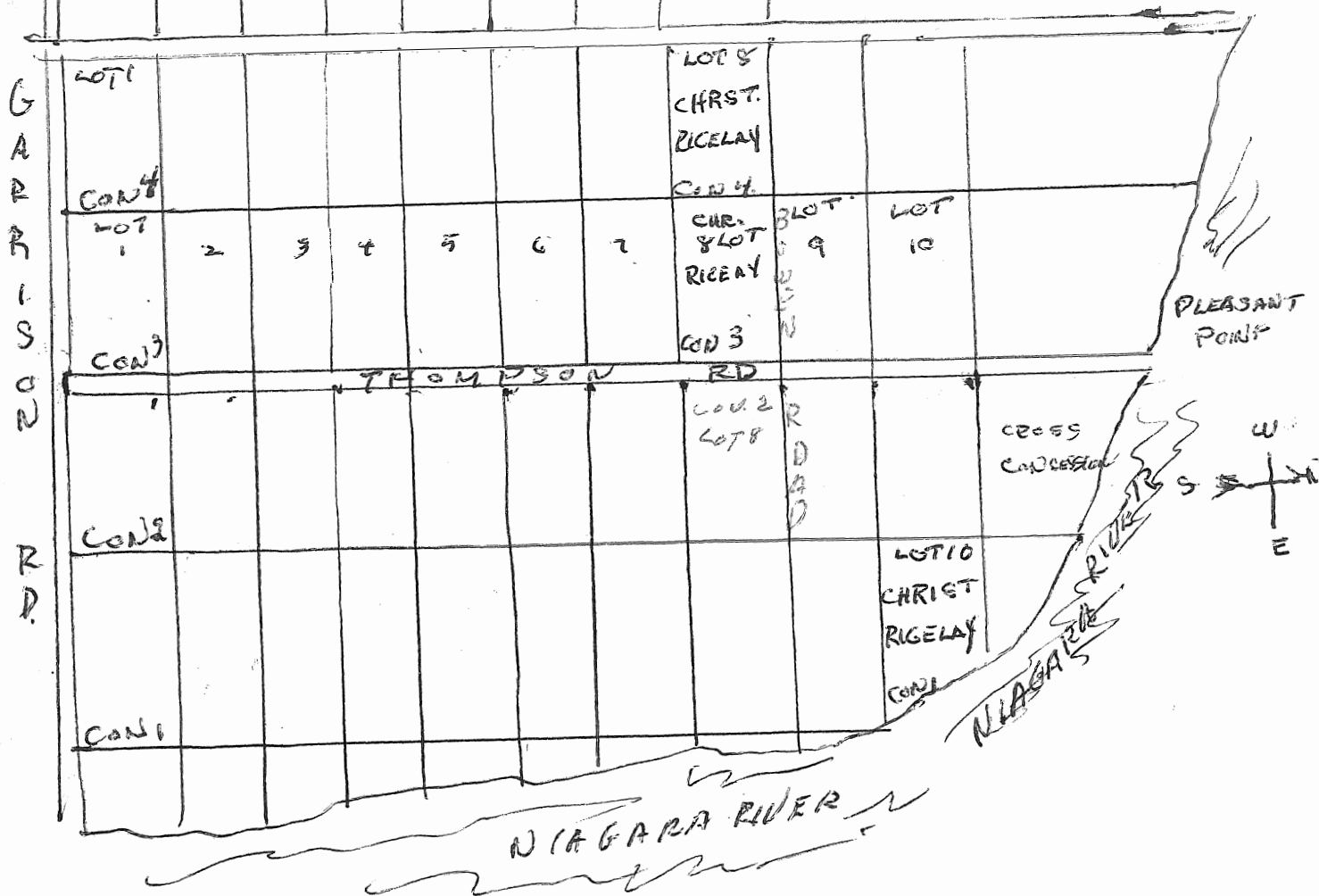

Riceley, (Riselay), Christian, lot ten in the first, lot eight in the third, and lot eight in the fourth concession from Niagara River.

Late a private in Butler's Rangers. His petition, read 7th July, 1796, stated that he had received 250 acres, and prayed for fifty acres due him as a ranger and for family lands for his wife and two children. The Council recommended him for fifty acres military lands but ruled that he was not entitled to family lands. A second petition, read 17th March, 1797, prayed for family lands and for land for his wife as the daughter of a loyalist. He was recommended for 100 acres family lands, and his wife, Kitty Riceley, was recommended for a grant of 200 acres. He was a town warden in 1811 and 1821. His house was